



Freedom to move
around in a barrier free
environment.

The lifting appliance
for wheelchair users
that makes it simple to
overcome staircases of
a few steps or several
levels.

ARCOlift

Platform Stairlift



ARCOlift

Functionality and safety in a single solution

Easy to use thanks to the platform and armrests motorised movement, ArcoLift allows overcoming a few steps or several floors in a simple and safe way.

Appropriately designed landing connection ramps to minimise inclination for an effortless access to the platform.

The Opening and Closure of the platform and armrests are comfortably operated from the landing push button control panel.

ArcoLift, in the rest position does not obstruct the staircase thanks to fold away platform and armrests.

Maximum hygiene and cleanliness is guaranteed by installing a dry guide rail not requiring oiling nor lubrication.

ArcoLift adapts to any type of staircase either it be straight or curved, as well as for internal and external environments.



EC CONFORMITY TO EUROPEAN STANDARDS

- . Machinery Directive 2006/42/EC
- . E.M.C. Directive 2004/108/EC
- . Safety requirement for Stairlifts EN 81-40 Standard



Technical Data	MOD SP108
Rated Load	250 Kg
Speed	6 m/min (0,10 m/sec)
Battery Charger	100 W
Power Consumption	
Protection level	IP55
Internal curving radius	200 mm
External curving radius	1200 mm
Max. Inclination	40°

The characteristics of the installation site are binding on the feasibility and lift type.



Useful Information

Basic features Arcolift Mod. SP108

- Automatic landing ramps with Gripface surface and Oversize dimensions to facilitate access to the platform by wheelchair users
- Motorised platform with anti-slip floor
- Motorised armrests, closing within the platform at the rest position against acts of vandalism
- Up / Down push buttons integrated on machine body requesting a constant pressure for operation
- Wireless push button control panels at landings activated by key, operating Call / Return controls (requiring a constant pressure) and Platform Opening / Closing control (One-touch)
- On / Off activation switch with extractable key
- Emergency stop button is fitted on the machine body
- 24V battery operated rechargeable at the guide extremity
- Safety sensors on the automated movements of the platform and armrests
- Safety sensors under the platform and on the machine body against the risk of impact or crushing during movements
- Parachute and overspeed controller safety devices
- Electrical and mechanical limit stops on the guide extremities
- Standard finishing: white machine body, dark grey platform floor dark gray rough finished guide rail
- Environmental service conditions: -10°C / +40°C for indoor or outdoor environment (not severe or extreme conditions)

Arcolift options

- Direct power supply connection kit: tension 115/230V 50/60Hz, consumption 1 Kw
- Direct landing control panels (available only with direct power supply connection kit)
- Extendable push button control panel for ground attendant
- Foldable seat
- Protective cover
- Movement warning lights along the path
- Movement warning light or acoustic signal on board
- Foldable guide rail at lower extremity or intermediate position



OVERALL DIMENSIONS

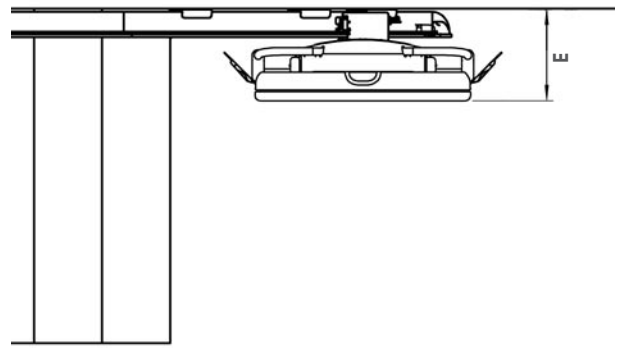
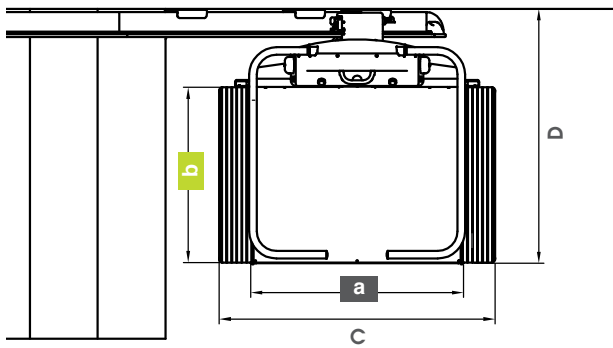
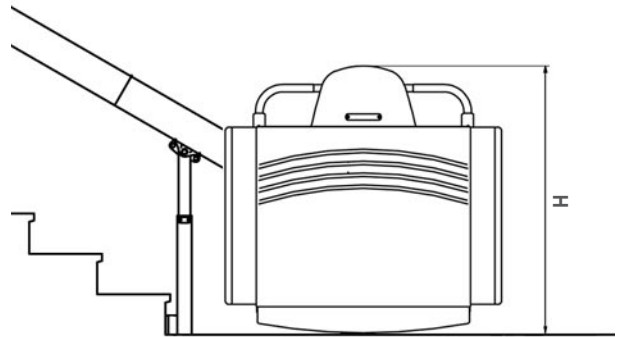
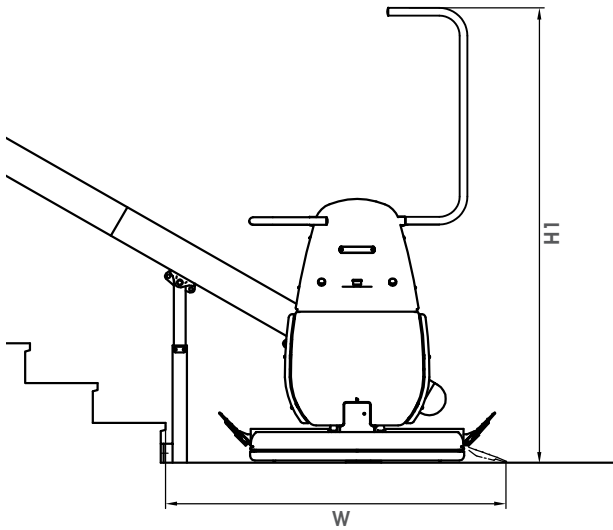

STAIRLIFT OVERALL DIMENSIONS

Net Dimension		C	D		E		H	W*			H1
a	b		Access N/F	Access A	Access N/F	Access A		Access N	Access F	Access A	
900	750	1170	1090	1270	390	480	1150	1440	2040	1440	1920
900	700	1170	1040	1220	390	510	1150	1440	2040	1440	1870
900	650	1170	990		420		1150	1440	2040		1820
900	600	1170	900		420		1150	1440	2040		1770

* Approximate for 30° guide rail inclination

Dimension Chart 1 > Parking Position at lower level

PLATFORM ACCESS

N - Opposite

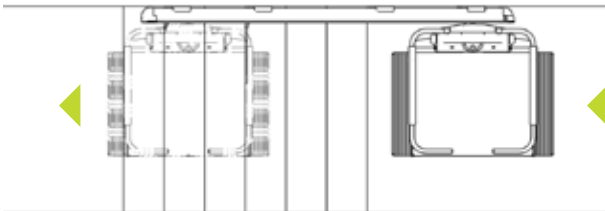

A - Adjacent (90°)

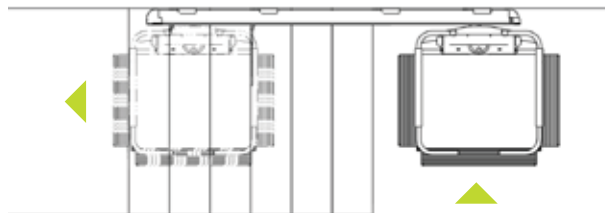

F - Frontal (same side)

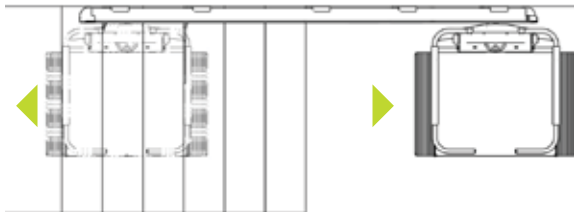

LANDING CONNECTION RAMP

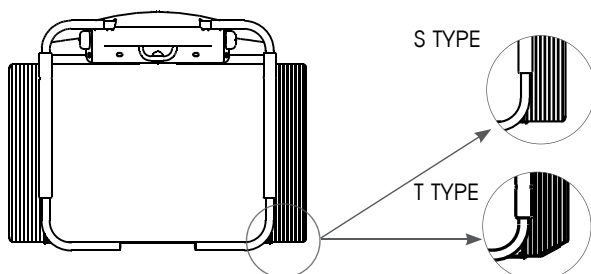

S type = Standard
T type = Rounded off

UTILITIES

Suggested manoeuvring spaces for wheelchair

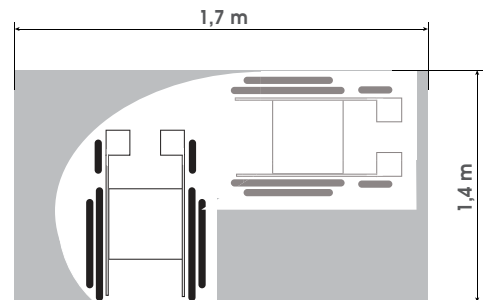

90° Curve

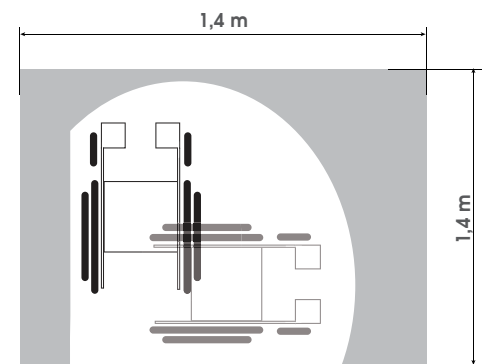

90° Rotation

Correct use of the stairlift

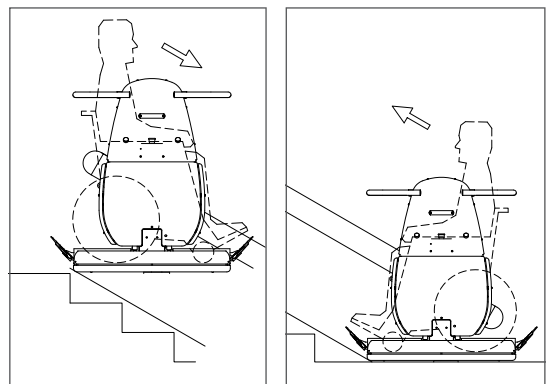

Dimension Chart 1 > Parking position at lower level

LEFT SIDE INSTALLATION – SX (LEFT SIDE)

SXR Left side straight parking position

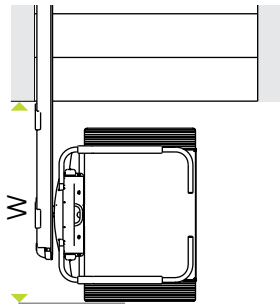

SX90 Left side 90° parking position (L curve)

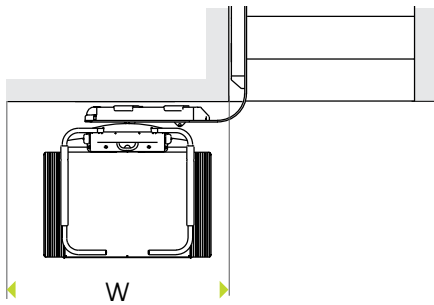

SX180 Left side 180° parking position (U curve)

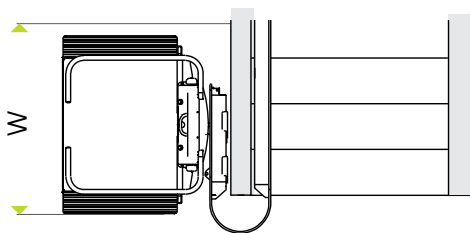

SXINC Foldable guide in parking position**

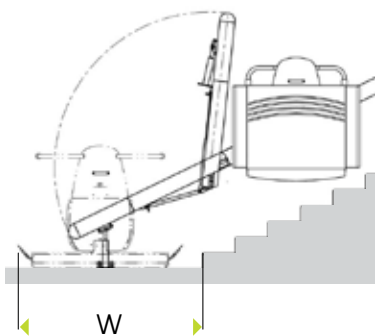

RIGHT SIDE INSTALLATION – DX (RIGHT SIDE)

DXR Right side straight parking position

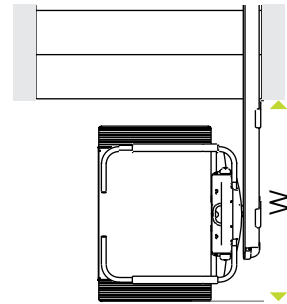

DX90 Right side 90° parking position (L curve)

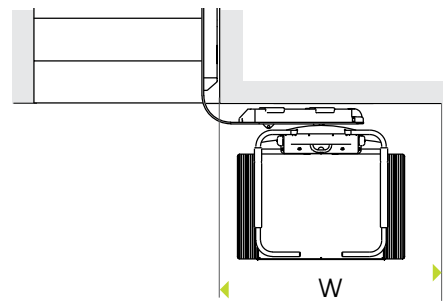

DX180 Right side 180° parking position (U curve)

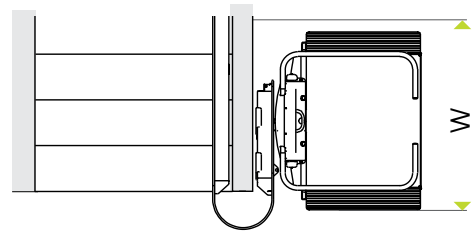

DXINC Foldable guide in parking position**

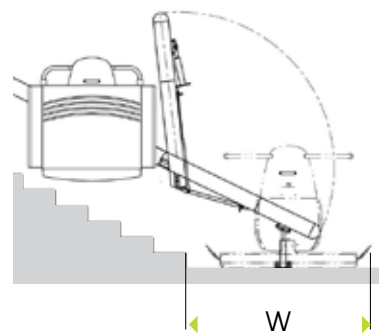

** Straight parking only

Dimension Chart 2 > Guide rail configuration

STRAIGHT STAIRCASE

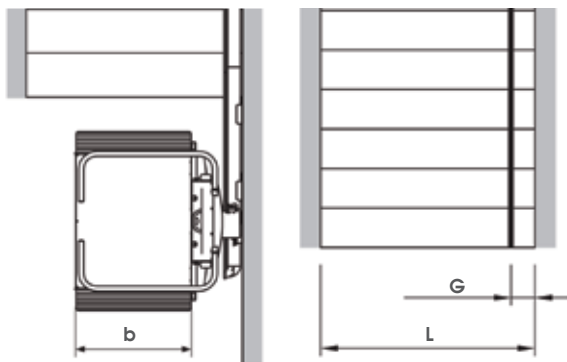
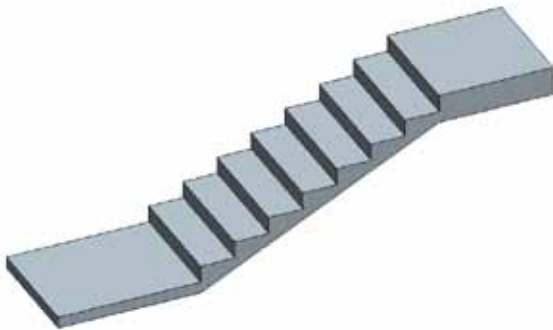

	RAMP "S"	b	L		G min
			Access N/F	Access A	
L	SP108-750	750	1140	1320	120
M	SP108-700	700	1090	1270	120
S	SP108-650	650	1040		120
XS	SP108-600	600	1000		120

	RAMP "T"	b	L		G min
			Access N/F	Access A	
L	SP108-750	750	1140		120
M	SP108-700	700	1090		120
S	SP108-650	650	1040		120
XS	SP108-600	600			

90° INTERNAL CURVE

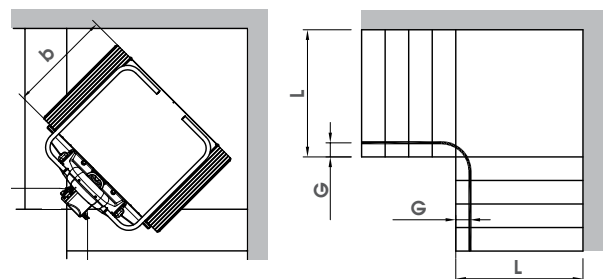
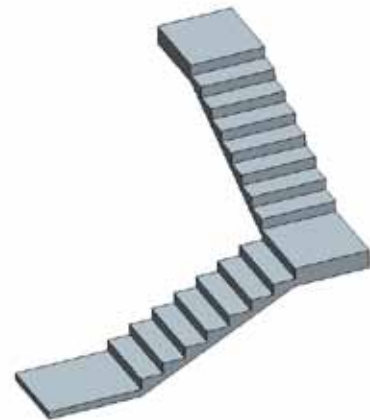

	RAMP "S"	b	L		G min
			Access N/F	Access A	
L	SP108-750	750	1300	1370	150
M	SP108-700	700	1250	1320	150
S	SP108-650	650	1200		150
XS	SP108-600	600	1150		150

	RAMP "T"	b	L		G min
			Access N/F	Access A	
L	SP108-750	750	1250		150
M	SP108-700	700	1200		150
S	SP108-650	650	1150		150
XS	SP108-600	600			

Dimension Chart 2 > Guide rail configuration

90° EXTERNAL CURVE

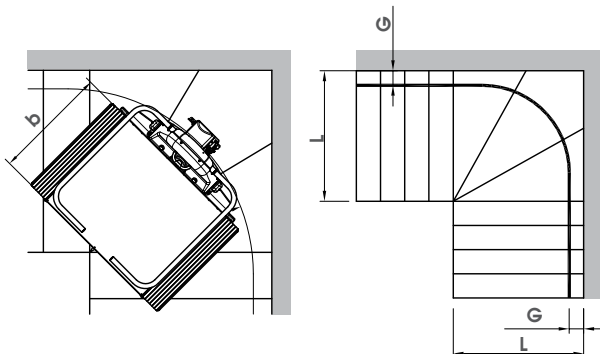
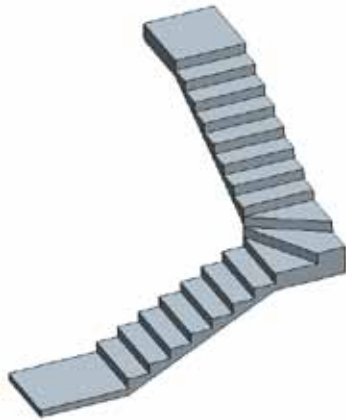

	RAMP "S"	b	L		G min
			Access N/F	Access A	
L	SP108-750	750	1180	1320	120
M	SP108-700	700	1145	1270	120
S	SP108-650	650	1110		120
XS	SP108-600	600	1075		120

	RAMP "T"	b	L		G min
			Access N/F	Access A	
L	SP108-750	750	1180		120
M	SP108-700	700	1145		120
S	SP108-650	650	1110		120
XS	SP108-600	600			

180° INTERNAL CURVE

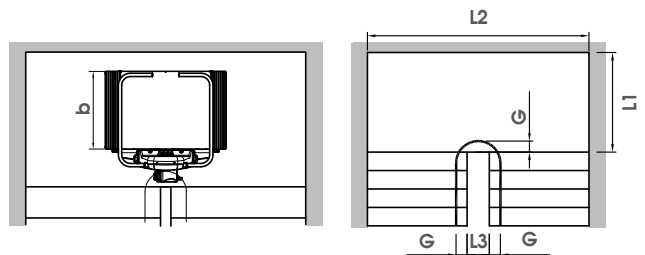
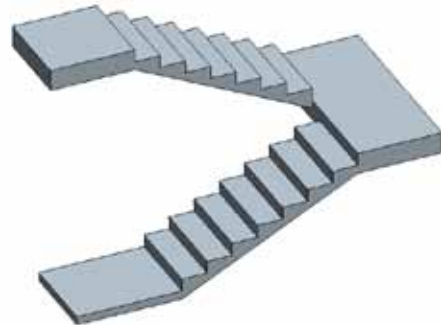

	RAMP "S"	b	L1	L2	L1	L2	L3 max	G min
			Access N/F		Access A			
L	SP108-750	750	1300	2700	1370	2840	100	150
M	SP108-700	700	1250	2600	1320	2740	100	150
S	SP108-650	650	1200	2500			100	150
XS	SP108-600	600	1150	2400			100	150

	RAMP "T"	b	L1	L2	L1	L2	L3 max	G min
			Access N/F		Access A			
L	SP108-750	750	1300	2600			100	150
M	SP108-700	700	1250	2500			100	150
S	SP108-650	650	1200	2400			100	150
XS	SP108-600	600						

Dimension Chart 2 > Guide rail configuration / Fixing solutions

180° EXTERNAL CURVE

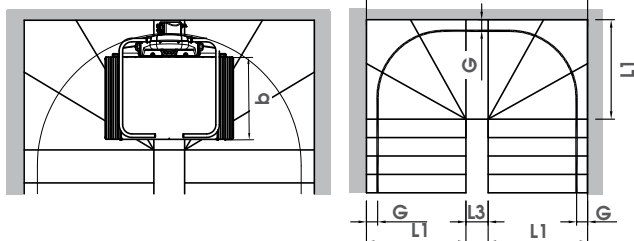
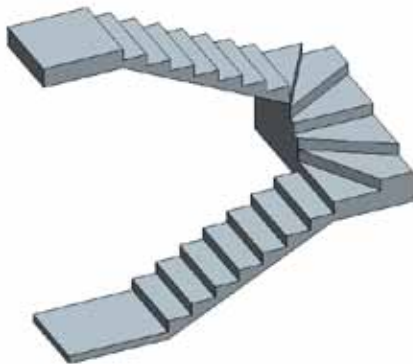

	RAMP "S"	b	L1	L3	L1	L3	L2 min	G min
			Access N/F		Access A			
L	SP108-750	750	1180	280	1320	50	2690	120
M	SP108-700	700	1145	350	1270	100	2640	120
S	SP108-650	650	1110	420			2640	120
XS	SP108-600	600	1075	420			2640	120

	RAMP "T"	b	L1	L3	L1	L3	L2 min	G min
			Access N/F		Access A			
L	SP108-750	750	1180	280			2640	120
M	SP108-700	700	1145	350			2640	120
S	SP108-650	650	1110	420			2640	120
XS	SP108-600	600						

* L3 > L3 MAX -> L2 = L2 MIN + (L3 - L3 MAX)

GUIDE RAIL MOUNTING

A Type Fixing: to the Step

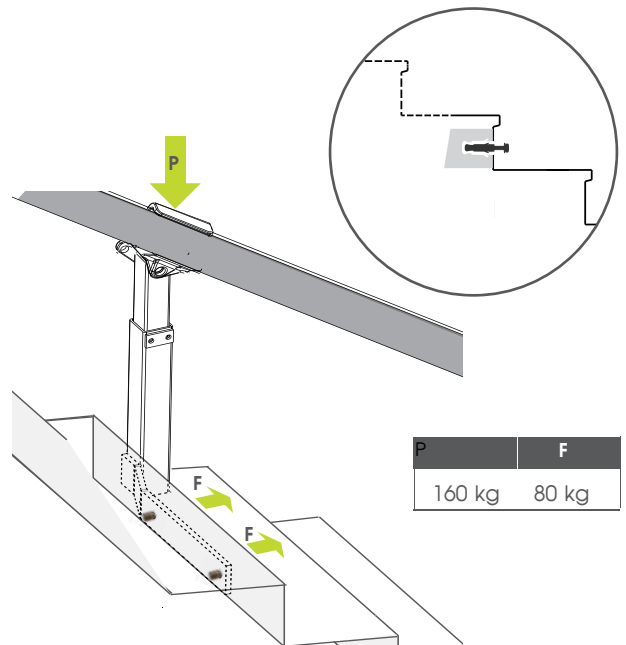

P	F
160 kg	80 kg

M Type Fixing: To Wall

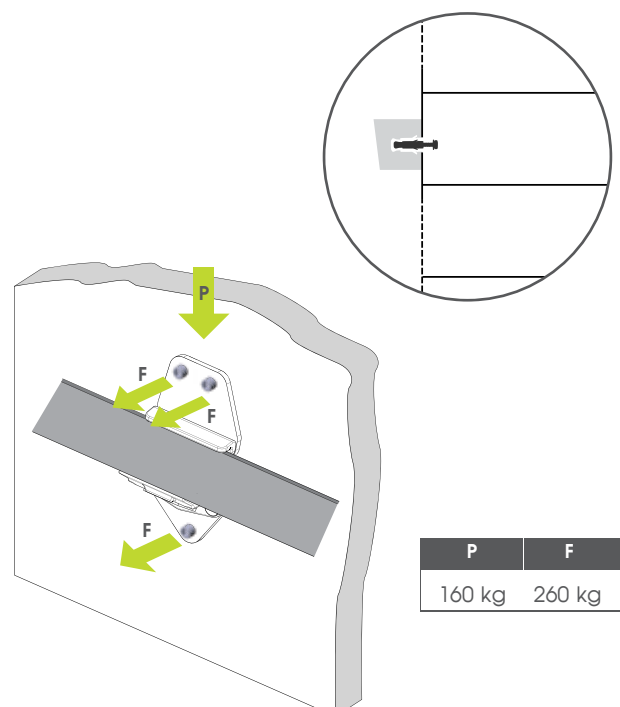

P	F
160 kg	260 kg

Chart 3 > Power supply > Battery charger

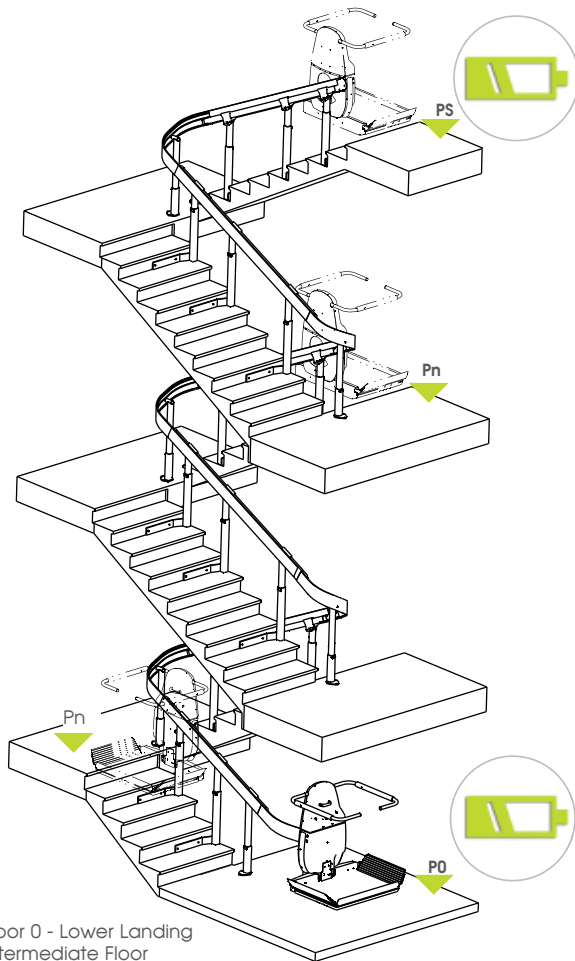

P0 Floor 0 - Lower Landing
Pn Intermediate Floor
Ps Upper Floor

LANDING CONTROL PANELS DETAIL

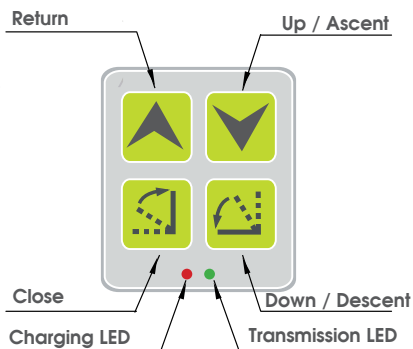

Call and Return buttons: Their operation requires constant pressure

Open and Close buttons: One-touch automatic type control to operate platform and armrest movements

BATTERY CHARGER

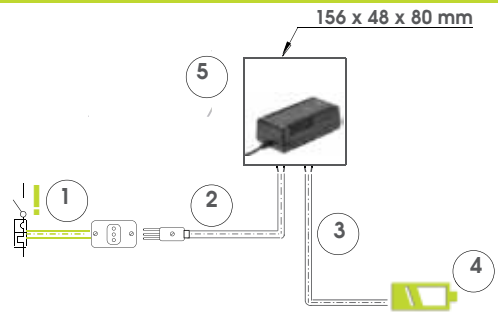

1 - Connection to the electrical power line

The customer shall provide a power line (INPUT 115/230V 50/60 Hz) fitted with a mains socket for plugging in the battery charger:

- The power line shall be fitted with a thermal magnetic circuit breaker (10A, trip sensitivity 30mA, C trip curve). The distance between the socket and the feeding point on the guide rail shall not exceed 2,5 m.

Power Consumption 1A - Power 0,1 kW

2 - Connection cable from the battery charger to the plug

Connection cable fitted with European plug for the connection of the battery charger to the mains socket. (Other kind of plugs are available as an optional request)

3 - Connection cable from the battery charger to the power charging point on the guide rail

4 - Power Charging Point - OUTPUT 24V 3A

The standard layout includes one power charging point installed at one of the guide rails extremity (lower or upper floor). Additional power charging points are available as an optional request.

5 - Battery charger

The battery charger cannot be directly exposed to weather elements or to humidity.

Environmental operating conditions: Humidity: 10% to 95%,
Temperature: 0°C to 30°C

If installed in a cabinet, a suitable aeration shall be guaranteed.

Suggested Cabinet minimum dimensions: 300 x 150 x 100 mm
(inside maximum temperature shall never exceed 30°C)

WIRELESS LANDING CONTROL PANELS

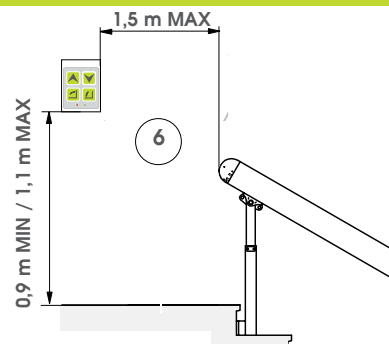

6 - Standard control panel at floors operate with remote control

Action radius of the wireless control panels: 20 m

Standard mounting: to the wall

Dimensions: 75 x 110 x 60 mm

Power supply: 4 x AAA 1,5V

Chart 3 > Power supply > Direct Power supply

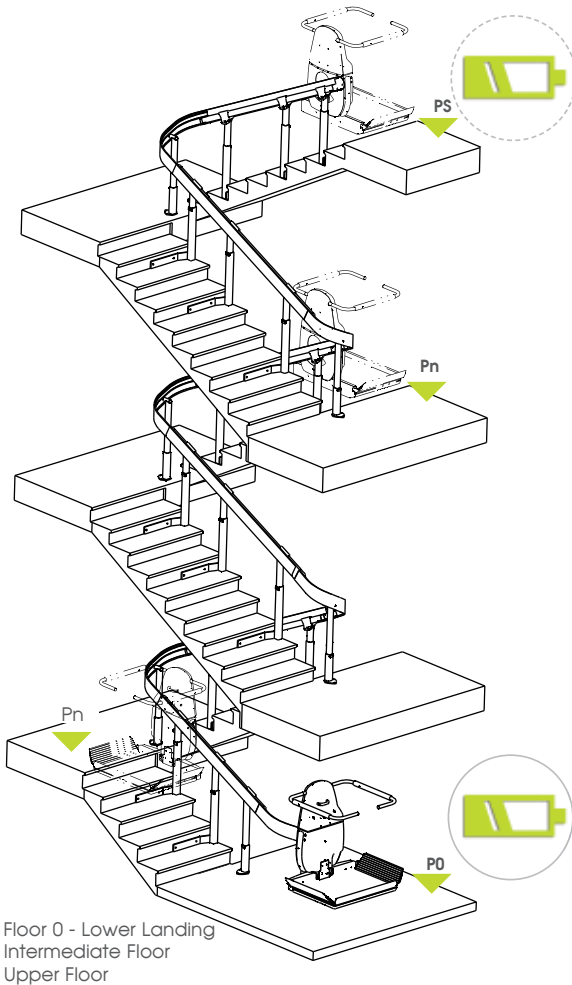

LANDING CONTROL PANELS DETAIL

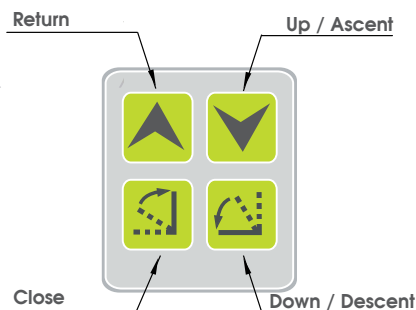

- Call and Return buttons:** Their operation requires constant pressure
- Open and Close buttons:** One-touch automatic type control to operate platform and armrest movements

MAIN POWER SUPPLY CONNECTIONS

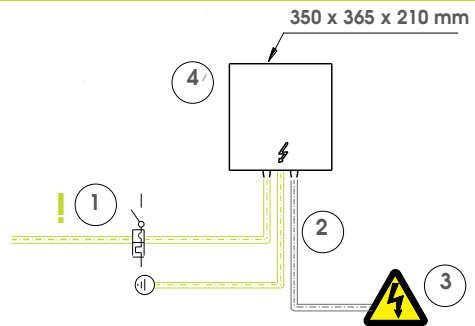

- 1 - Connection to the electrical power**
The customer shall provide a dedicated power line:
INPUT voltage 115/230V 50/60-Hz
The power line shall be fitted with:
- a thermal magnetic circuit breaker (10A, trip sensitivity 30mA, C trip curve)
- A cable 3 x 1,5 m2 for the connection to the controller cabinet. (minimum tube diameter to allow the cable passage: 20 mm)
Note: The line shall be fitted with a connection to earth
Power consumption: 8A - 1 kW
- 2 - Connection from the cabinet to the guide rail**
The customer shall provide a suitable tube passage diameter 20 mm min. to hold the connection cable (Cable 2 x 6 mm2)
- 3- Power feeding point - OUTPUT 24V 40A**
The power feeding point is placed at one of the guide rails extremity (lower or upper floor).
- 4 - Controller cabinet**
The cabinet shall be mounted to the wall and be easily accessible for maintenance purposes (suggested height 1,5m)
The cabinet cannot be directly exposed to weather elements or to humidity.
Environmental operating conditions: Humidity: 10% to 95%.
Temperature: 0°C to 30°C
Suitable aeration shall always be guaranteed.

LANDING CONTROL PANELS CONNECTIONS

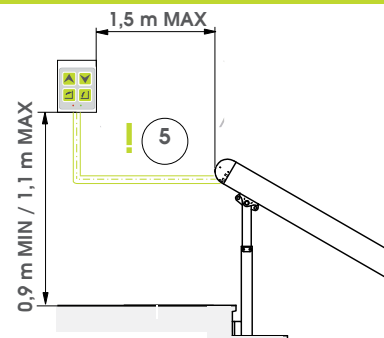

- 5 - Standard control panel at floors operate with remote control**
Action radius of the wireless control panels: 20 m
Standard mounting: to the wall
Dimensions: 75 x 110 x 60 mm
The customer shall provide:
- A tube passage for cables: min. diameter 20 mm

Manufacturing and Premises

SITES SRL

Via Cavalieri di Vittorio Veneto

23870 Cernusco Lombardone - LC (Italy)

Tel +39 039 999 18.1

Fax +39 039 999 18.55

info@sites.it

Data, technical features and finishing are non-binding and may change without notice



by **SITES**
FreeLifeSTYLE
www.freelifestyle.eu